

HITACHI 2 H.P. MOTOR  
MODEL NO. MT320-07

<u>Item No.</u>	<u>Part No.</u>	<u>Description</u>	<u>Qty.</u>
1.	1011315	F-Bracket Bolt	4
2.	1011316	Oil Seal	1
3.	1011317	Ball Bearing	1
4.	1011318	Bearing Retainer	1
5.	1011319	Ball Bearing	1
6.	1011320	Insulating Washer	4
7.	1011321	(B) Bracket Bolt	4
8.	1011322	Bearing Retainer Screw	4
9.	1011323	Insulating Tube	2
10.	1011324	Terminal Bolt	2
11.	1011421	Jumper Wire Package (2 Pcs.)	1
12.	1011326	Brush Holder Assembly	1
13.	1011327	Insulating Tube	2
14.	1011328	Field Coil	1
15.	1011420	Brush Spring Package (4 Pcs.)	1
16.	1011422	Pole Piece Bolt Package (8 Pcs.)	1
17.	1011423	Pole Piece Package (4 Pcs.)	1
18.	1011424	Brush Package (4 Pcs.)	1
19.	1011333	Brush Screw	4
20.	1011334	Brush Cover	4
21.	1011335	Brush Holder Assembly Screw	4
22.	1011347	Terminal Kit	4

INCLUDE PART NUMBER OF EACH PART ORDERED AND SERIAL NUMBER OF CAR

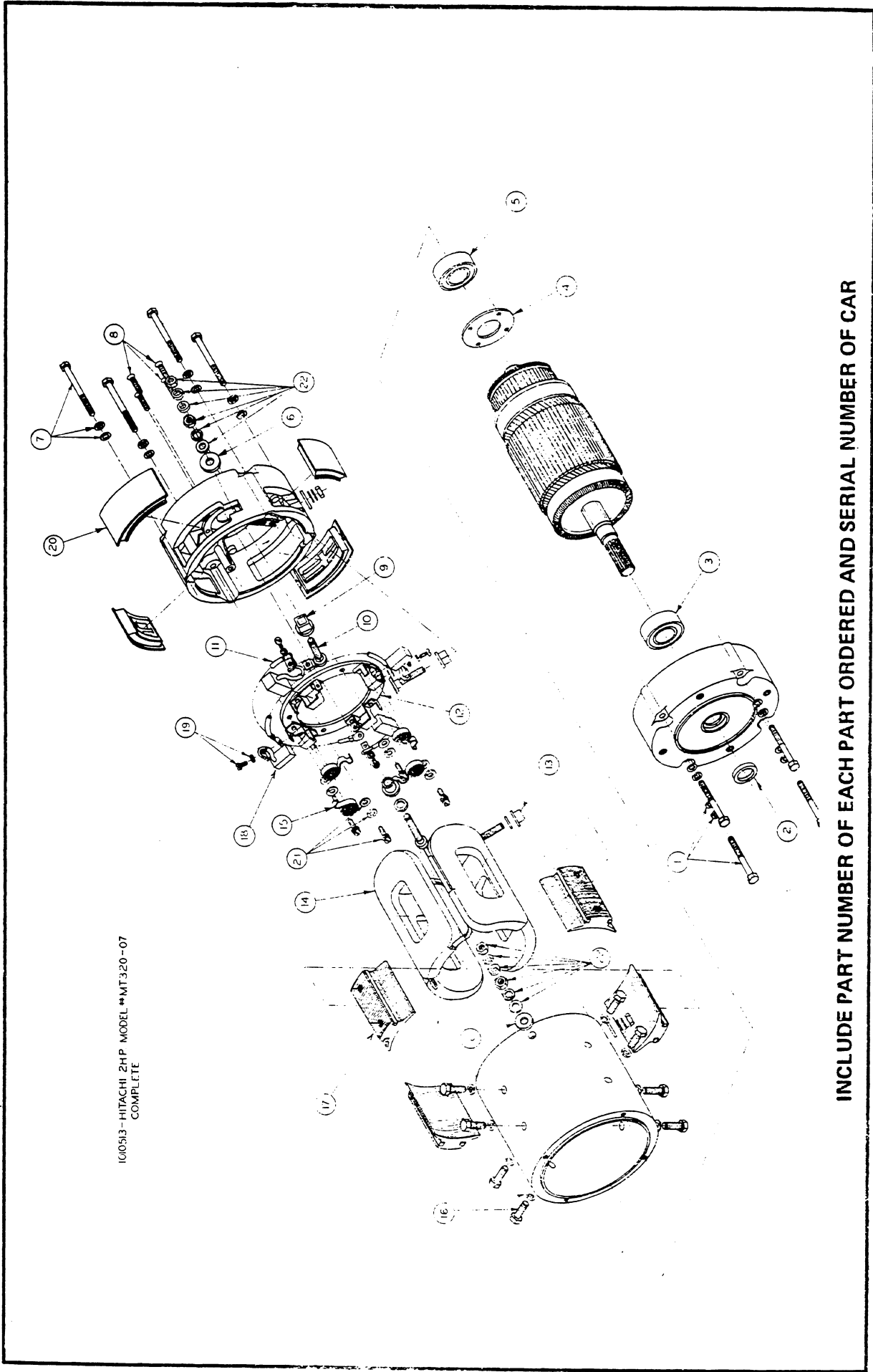

100513-HITACHI 2HP MODEL #MT320-07  
COMPLETE

INCLUDE PART NUMBER OF EACH PART ORDERED AND SERIAL NUMBER OF CAR

Issue Date 8/1/83  
Effective Serial No. A8036-15260 thru A8405-50906